

*Electropower*

# **ADEPTA** **Helical** **Geared** **Motors**

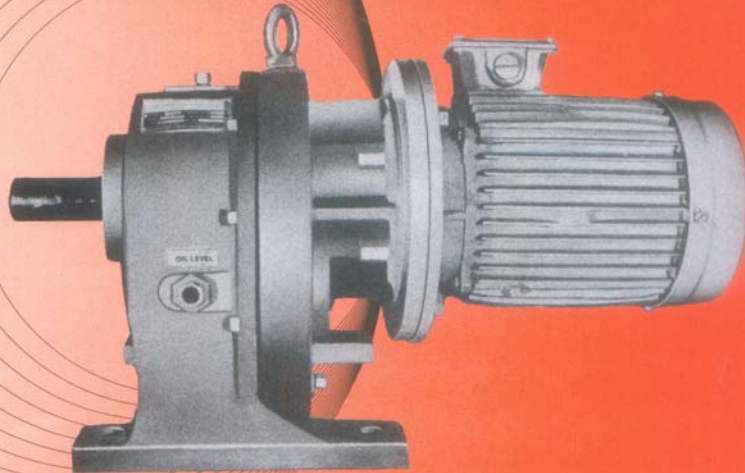

Super Standard Range  
(0.18KW to 3.75 KW)  
Output Speeds 24 to 125 rpm.

## **ADEPTA**

- Complete Metric Design
- Adaptable to Electric Motors made to IEC/ISI Frames
- Foot as well as Flange Mounting Construction
- Alloy Steel Gears-Heat treated and lapped for lasting service
- Inspected and tested for Perfect Motor fitment

Also available **ADEPTA** Worm Geared Motors / Gear Boxes

**ADEPTA** eliminates two most common problems facing industrial Progress today

SLOW DELIVERIES

ESCALATING COSTS

**ADEPTA** enables mounting of IEC Flanged B5/V1 Construction Electric Motors of your choice

**ADEPTA** an Exquisite range of parallel shaft geared motors (24-125 RPM 0.25HP through 5 HP capacities) that covers approx. 60% of the Industrial requirement is taken up for volume production ensuring you

HP RPM	0.25	0.5	1	2	3	5
24 T	G1.71 7.4	G2.90 15.8	G3.90 31.5	G3.100 63	G5.112 94	-
35	G0.63 4.85	G1.71 9.7	G2.80 19.4	G3.90 38.8	G3.100 58.2	G5.112 97
52	G0.63 3.3	G1.71 6.5	G2.80 13.2	G3.90 26.5	G3.100 40	G5.112 66
82	F2.63 1.8	G0.71 3.5	G1.81 7.5	G2.90 15.0	G3.100 22.5	G5.112 40
125	F2.63 1.35	F2.71 2.7	G1.80 5.4	G2.90 10.8	G3.100 21.6	G3.112 27

● T = Torque in kgm  
Use input speed 1440, except for 24 output, 940 RPM.

PROMPT DELIVERIES

REASONABLE COSTS

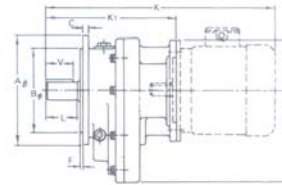
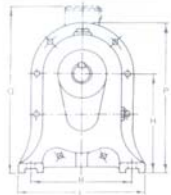
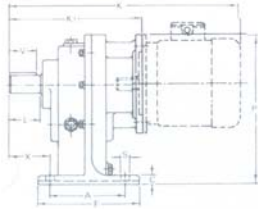

FRAME	OVERALL DETAILS							FIXING DETAILS					SHAFT DETAILS					OVERALL DETAILS				FIXING DETAILS							
	E	F	K	K1	P	P1	Q	A	B	C	H	S	X	D	L	T	U	V	K	K1	P	Q	A	B	C	E	F	H	S
F2.63	120	125	375	180	130	150	194	95	100	8	80	9	50	16	35	18	5	130	375	175	145	190	90	60	8	75	3	75	7
F2.71	120	125	375	180	130	150	200												405	175	155	195							
G0.63	145	150	400	206	175	178	210	115	120	12	108	10	54	22	40	24.5	6	35	400	206	175	196	130	80	10	100	3	105	10
G0.71	145	150	420	215	175	188	220												420	215	185	220							
G1.71	175	185	450	245	195	200	235	135	145	15	120	13	65	28	60	31	8	55	450	245	197	230	180	110	10	155	3	117	13
G1.80	175	185	505	265	195	220	240												505	265	217	240							
G2.80	200	230	510	270	245	252	275	160	190	15	152	14	72	28	60	31	8	55	510	270	248	270	215	150	12	180	4	148	14
G2.90	200	230	570	270	245	252	280												570	270	248	280							
G2.100	200	230	600	280	245	277	290												600	280	273	290							
G3.90	250	310	625	325	295	284	315	200	260	20	184	17	95	38	75	41	10	70	625	325	281	310	260	180	16	220	4	181	17
G3.100	250	310	655	335	295	309	320												655	335	306	320							
G3.112	250	310	685	335	295	309	335												685	335	306	330							
G5.112	370	395	750	400	405	380	405	300	320	25	255	24	100	60	115	65	18	100	750	400	373	395	350	250	20	300	4	248	20

*Narhari Engineering Works Pvt. Ltd.*

1, Shah Industrial Estate, Off. Veera Desai Road, Andheri (W), Mumbai -400 053.

Tel.: 2673 18 25, 2673 18 93, Fax: 2673 2107.

Web Site : [www.geared-motor.com](http://www.geared-motor.com) E-mail : [gearedmotor@vsnl.com](mailto:gearedmotor@vsnl.com)